

RAK-METROPOLITAN-W/HIDDEN FIXATIONS

Sospeso | WC

RAK
CERAMICS

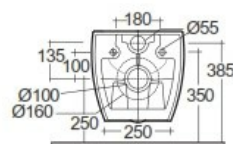
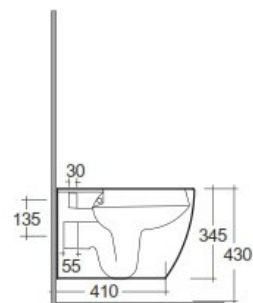
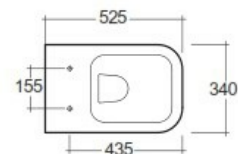

Scheda tecnica

Dimensioni:	525 x 337 mm
Peso:	28 Kg
Colore:	bianco alpino
Tipo di scarico:	A parete
Sifone:	Nascosto
Opzioni del sedile:	ABS e UREA
Forma:	Rettangolare Arrotondata
Chiusura rallentata:	sì
Doppio scarico:	sì
Collezione:	RAK-METROPOLITAN

Codice Nome

MP13AWHA	METROPOLITAN WATER CLOSET RIMLESS WALL HUNG W/HIDDEN FIXATIONS 52CM
----------	---

Dimensions: All dimensions in mm. Tolerance of vitreous china & fireclay items: $\pm 5\%$ for below 200mm and $\pm 3\%$ for above 200mm; for all other items tolerance $\pm 1\%$. Note: Due to a continuing development program to improve design and performance, the manufacturer reserves all rights to vary specifications without prior information. Please note accessories are for photographic use only.